

Mounting template

Cut four screw holes (one in each corner) and two holes for the DB9 connector.
All measurements are in millimetres.

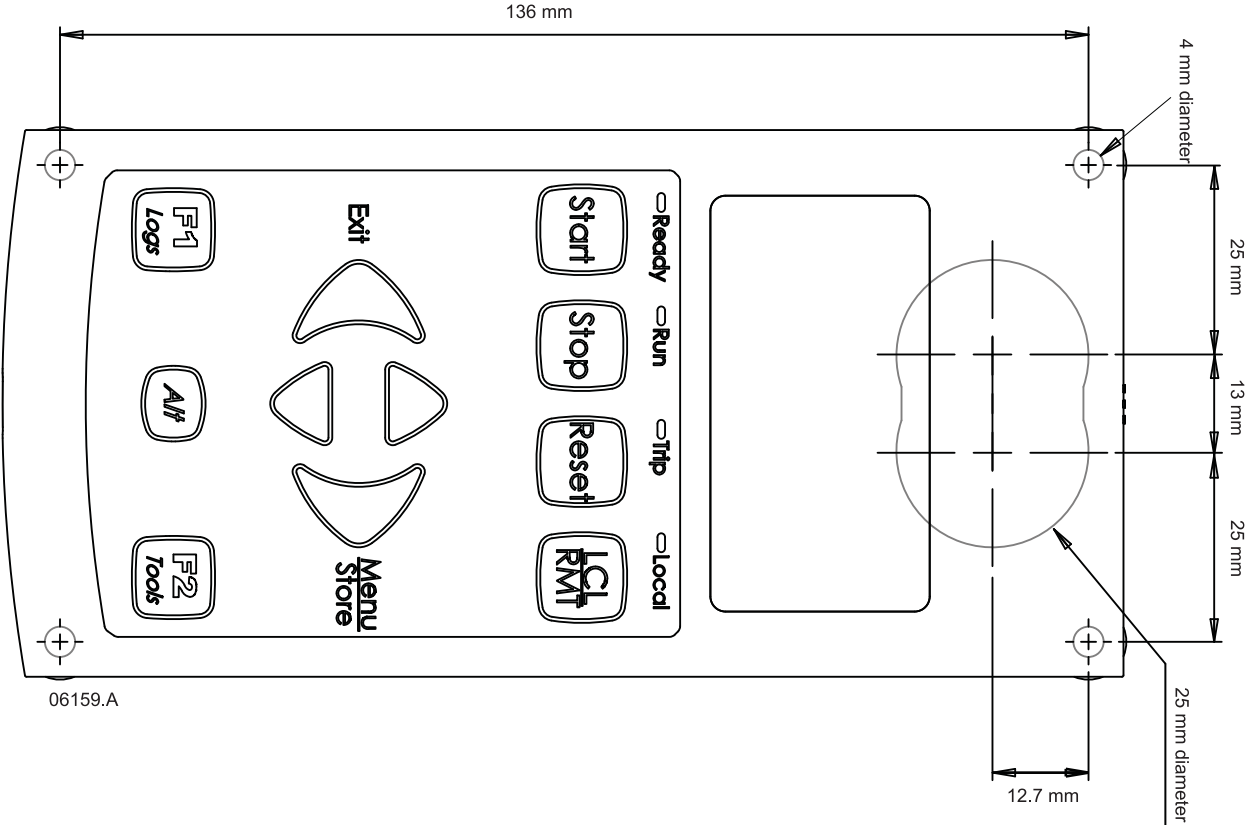

EMX3 Soft Starter

Keypad Remote Mounting Kit Instructions

The EMX3 keypad can be remotely mounted up to 3 metres away from the soft starter, allowing remote control and monitoring. The keypad can be supplied together with the soft starter or as a separate item. Different kits are available with two or three metre cables.

The keypad can be connected and disconnected while the starter is still powered up. It is not necessary to disconnect the soft starter from power sources before connecting or disconnecting the keypad.

The keypad is rated IP65 when mounted correctly using the Remote Mounting Kit.

PACKING LIST: Remote Mounting Kit

995-04939-00	995-08133-00
1 x Cable, DB9, 2 metres	1 x Cable, DB9, 3 metres
1 x Gasket	1 x Gasket
4 x Screw, M3 x 16	4 x Screw, M3 x 16
4 x Flat washer, M3	4 x Flat washer, M3
4 x Spring washer, M3	4 x Spring washer, M3
4 x Nut, M3	4 x Nut, M3
2 x Jack screw	2 x Jack screw
1 x Instructions	1 x Instructions

Removing the keypad from the EMX3

When purchased with the starter, the keypad is attached to the body of the starter by a DB9 serial connector and two screws. The screws are concealed behind a snap-on faceplate.

To remove the keypad from the soft starter:

1. Open the EMX3's door.
2. Insert a small screwdriver under the faceplate, at the base of the keypad, and use the screwdriver to lever the faceplate off the keypad.
3. Lift the faceplate off completely.
4. Remove the two screws holding the keypad in place. To avoid losing the screws, these can be replaced in the body of the soft starter.
5. Lift the keypad gently off the soft starter. Pull the keypad forwards, to avoid damaging the DB9 connector.

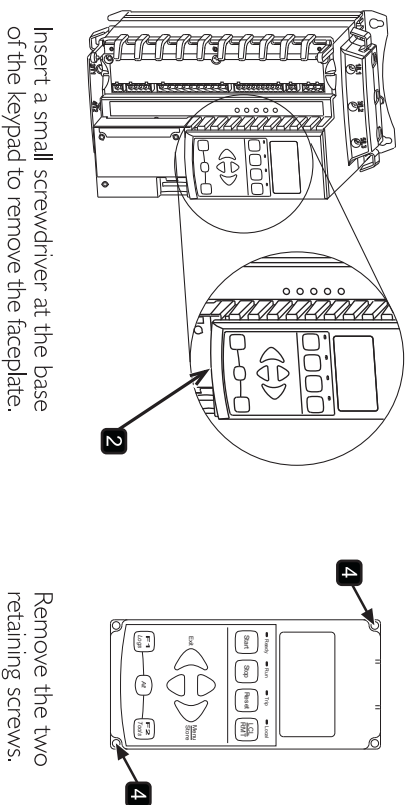

Preparing the keypad for remote mounting

The remote mounting kit includes a self-adhesive foam gasket, which forms a seal between the keypad and the panel to provide IP65 protection.

1. Screw the two jack screws into the holes on each side of the DB9 connector on the back of the keypad.
2. Peel the paper backing off the gasket and press the sticky side onto the back of the keypad. Take care to align the screw holes in the corners of the gasket with the screw holes in the keypad.

Mounting the keypad

1. Use the template on the back page to cut four (4) screw holes and two holes for the DB9 connector at the required location in the panel.
2. Place the keypad, with gasket attached, over the mounting location so that the screw holes are aligned and the DB9 connector can be seen through the cut-out.
3. Secure the keypad to the panel using the supplied screws (4).
4. Tighten all four screws so that the foam gasket is compressed to approximately half its original thickness. If the screws are too loose, the gasket will not provide IP65 protection. Over-tightening the screws can damage the keypad, gasket or panel.
5. Plug the DB9 cable into the connector on the back of the keypad and screw the cable connector into the jack screws (2). Plug the other end into the connector on the soft starter. The keypad display should activate.
6. Press the faceplate onto the front of the keypad.

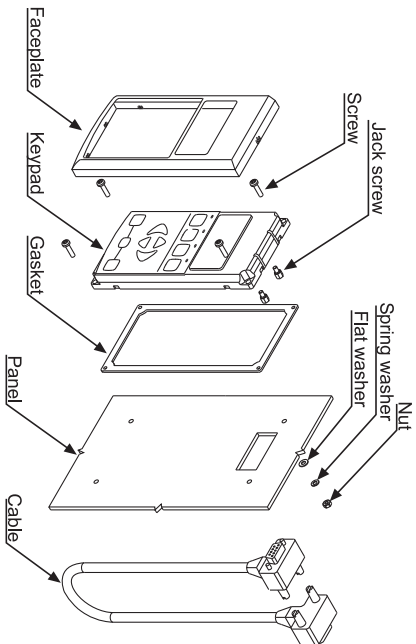

Synchronising the keypad and the soft starter

When a keypad is connected to an EMX3, it synchronises its parameter settings with the settings in the soft starter.

The default action is to copy the parameter settings from the keypad to the soft starter. To change the action, use the ▲ and ▼ buttons. Press STORE to proceed.

If any of the settings in the keypad are not valid for the starter, the keypad will prompt to use the default values.

If the number of parameters stored in the EMX3 is

different from the number in the keypad (eg because of different software versions), the soft starter's parameter list must be copied into the keypad.

Copy Parameters
Keypad to Starter

Par: 1-A Out of Range
Store to set default

Parameter Set Mismatch
Cannot Copy
Store to continue